



**FIREscape+**

## GLOBALLY PROVEN PRODUCT DESIGN

The **FIREscape+** system is the first of its type and integrates Hochiki's highly successful **FIREscape** emergency lighting system with its acclaimed **ESP** fire detection system. By integrating both of these systems onto the same panel and onto the same loop wiring, not only does the emergency lighting become operational in the event of a fire – without the need for a mains supply failure to have occurred - but based on the location of the fire, people are directed away from unsafe exit routes using Hochiki's intelligent signage.

This is achieved by creating dual function exit signs. Under normal circumstances the exit sign is illuminated and carries the internationally recognised symbols of a running man, door and direction arrow. However, in the event of a fire affecting a specific escape route, the appropriate signage is switched off and replaced by an illuminated RED "X" symbol.

Example -



Unlike other systems, where each luminaire requires a 230 V supply, the entire **FIREscape+** system operates at extra low voltage. Utilising only Extra Low voltage devices, means that the luminaires are fitted to the same style of plug-in base as the fire detectors, which allows installation

and maintenance to be carried out by engineers other than qualified electricians, thereby producing a very cost effective solution.

## INTELLIGENT SYSTEM

**FIREscape+** is an intelligent system. All of the devices – fire sensors, sounders and beacons, emergency luminaires and exit signs - are individually addressed and fully monitored by the system control panel. By automatically monitoring all of the key elements of each device the need for regular inspection is significantly reduced\*. The failure of any device is immediately registered on the main control panel with both audible and visual warnings.

## ENERGY EFFICIENCY & GREEN VALUES

**FIREscape+** incorporates LED technology and Lithium Polymer batteries into all emergency luminaires and signs. When compared with traditional fluorescent light technology, energy and CO<sub>2</sub>e emission savings in excess of 95% are achievable.



\*Note: Local or national standards may still require a regular testing and inspection scheme.







## COMPANY OVERVIEW

Established in Japan in 1918, Hochiki is an independent, multi-national, publicly listed company with over 1700 employees across the globe. One of the world's leading manufacturers of commercial and industrial fire detection and emergency lighting solutions, Hochiki has acquired global acceptance as the benchmark for high-integrity and long-term reliability.

Hochiki's facilities in Japan, the United States of America and Europe design and manufacture products and provide technical support suited to local standards and customer requirements. Total commitment to meeting the needs of individual national markets has reinforced the company's global reputation, resulting in Hochiki products being installed in many prestigious sites and in over 80 countries worldwide.



STATISTICS TAKEN FROM THE HOCHIKI CUSTOMER SERVICE SURVEY DECEMBER 2016



Respondents rated product quality as either 'very good' or 'excellent'



Customers stated our market reputation is 'very good' or 'excellent'



Customers are most likely to recommend our products

# **FIREscape+**

## **KEY FEATURES & BENEFITS**

### **ONE CONTROL PANEL**

To create a combined emergency lighting and fire detection system, only the one control panel and operator interface is required.

### **SAFETY GUIDANCE**

During an emergency, people are provided with directional guidance to help find their escape route quicker and return to safety.

### **COST EFFICIENT**

Cost efficiency throughout the entire product life cycle – from installation to operation, maintenance and recycling

### **INHERENT RELIABILITY**

Minimum of 10 years system life expectancy (battery life expectancy is at least 5 years).

### **QUALITY & RELIABILITY**

The **FIREscape+** system complies with all British and European emergency lighting standards, in particular BS5266 for the design and installation of emergency lighting systems. Luminaires and exit signs are also BS kitemarked.

### **ENVIRONMENTALLY FRIENDLY**

All of the Hochiki components are environmentally friendly, including – batteries, plastics and electronics are fully recyclable. Reduced energy requirements result in reduced carbon footprint for end-user.

### **FALSE ALARM REDUCTION**

With the robust Hochiki **ESP** protocol, there is a significant reduction in the potential for false or unwanted alarms.

### **NO MAINS SUPPLY REQUIRED AT DEVICE**

In this combined system none of the devices, including luminaires and exit signs require mains supply.

### **AUTOMATIC TESTING**

All of the emergency luminaires and exit signs have an automatic testing function.

### **EXCLUSIVELY**

**FIREscape+** is available exclusively through our Systems Partners Network.

### **REDUCED COST OF OWNERSHIP**

There are lower installation costs by integrating fire detection and emergency lighting onto the same cable, a 40% reduction in installation costs is achievable when compared to the installation of two independent systems. Additionally, less visits from engineers are required as maintenance can be conducted on the one system as a whole. As there is one common central control panel and a series of common field equipment, there are significantly less products required to service. This both reduces costs and minimises the downtime potential should a failure occur. Finally, the system can achieve a longer operating life as LEDs have a typical operational life expectancy of 10 years, compared to 9 months for an 8W fluorescent lamp (in maintained mode).

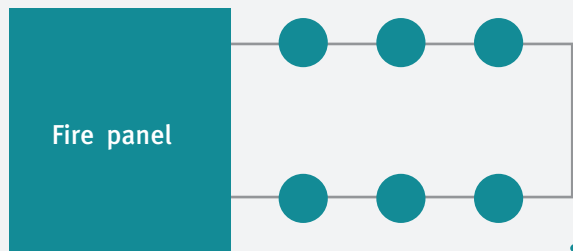

Traditional Fire System

# FIREscape+

New combined fire and emergency lighting system

Traditional Emergency Lighting System

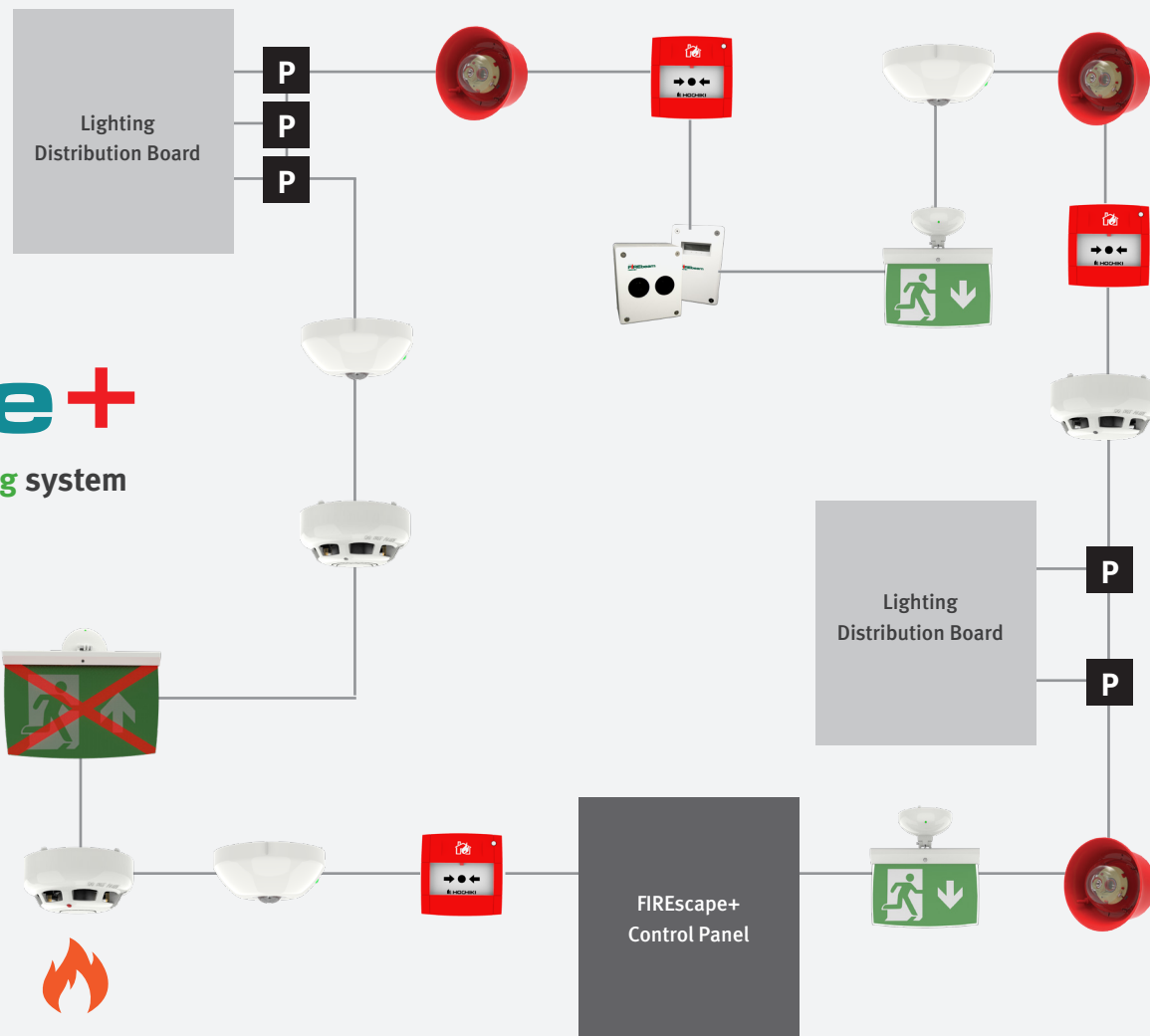
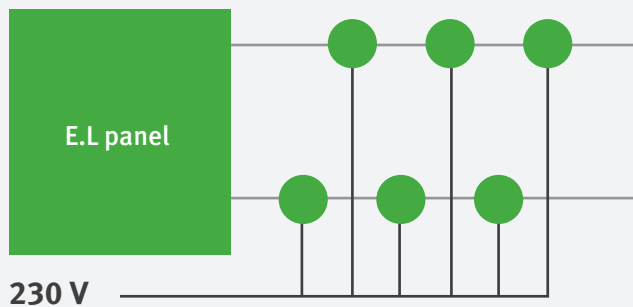

## ROSSE SYSTEMS

4 Peel House, Taunton St, Shipley,  
BD18 3NA, United Kingdom  
Telephone: +44 (0)1274 595015  
Facsimile: +44 (0)1274 580804  
sales@rosse-systems.co.uk  
www.rosse-systems.co.uk

9-5-0-563/ISS4/NOV18



Quality Systems Certificate  
No. 164  
Assessed to ISO 9001  
Environmental Management  
Certificate No. EMS 164  
Assessed to ISO 14001



Business Member



Fire Industry Association



Affiliate Member



Construction CPD  
Certification  
Service



KM 653255  
BS EN60598-1:2015  
BS EN 60598-2-22:2014  
Emergency Luminaires

**Your Safety, Our Technology**